



Home & Land Packages



THE SEACOMBE

**LOT 2346 TRITON ST
SEAFORD MEADOWS**

This package includes:

- 374m² of land in the ever popular Seaford Meadows
- Rossdale Homes Seacombe courtyard built to Sovereign Specifications with 2.7m ceilings
- Front elevation rendered and painted allowing 2 colors and feature front door in Western Red Cedar
- Double garage with automatic panel lift doors and internal access
- Healthy footings allowance with all excess soil removed from site
- Reclaimed water service as per Seaford encumbrances
- NBN wiring is included for super fast internet
- Ceiling and External wall insulation
- Master bedroom with his and hers built in robes with mirrored doors and a fantastic ensuite layout
- Bedrooms 2 & 3 with mirrored built in robes
- Instantaneous hot water system for endless hot water supply
- Quality Westinghouse appliances to kitchen including retracta range-hood set in overhead cupboards
- 25 Year Structural Warranty
- 100% Absolute Fixed Price Contract with no hidden costs
- More options available for this package, call today to find out more

PACKAGE FROM: \$389,000

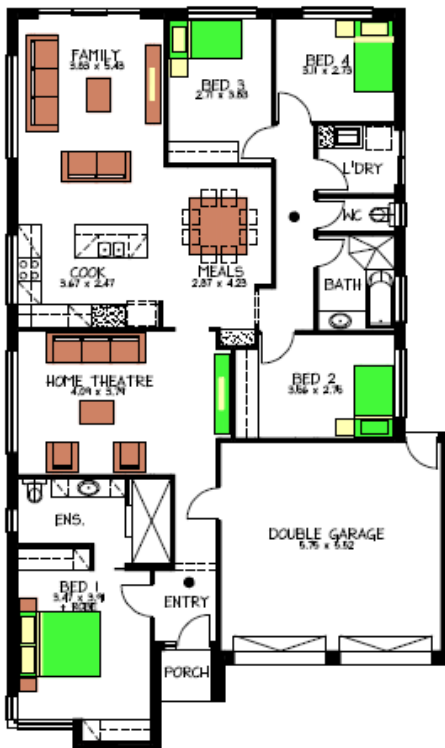

Disclaimer: All care has been taken in the preparation of this material. No responsibility is taken for any errors or omissions. Details are subject to change without notification. Images for illustration purposes only. E&EO.

**FOR THIS OFFER CALL
BRAD: 0421 940 398**

P: 08 8433 2000 www.rossdalehomes.com.au

**ROSSDALE
HOMES** *Because trust is a must.*